

Main Technical Parameter

Nominal pressure	64	psi
Test pressure	Shell test Pressure	9.60
	Tightness test	7.04
Gas-Tightness test		0.6
Max working temperature	-29 ~ +425	°C
Applicable medium: Water, Steam, Steam-water-mixture, etc		

CONFIGURATION DIMENSION

NPS	1/2"	3/4"	1"
NPT	1/2"	3/4"	1"
L	60	70	80
H1	41	45	56
H	55	60	72

MAIN PARTS AND MATERIALS

NO.	PART NAME	MATERIAL	NO.	PART NAME	MATERIAL
1	Body	A182 F316			
2	Disc	A182 F316			
3	Cover	A182 F316			

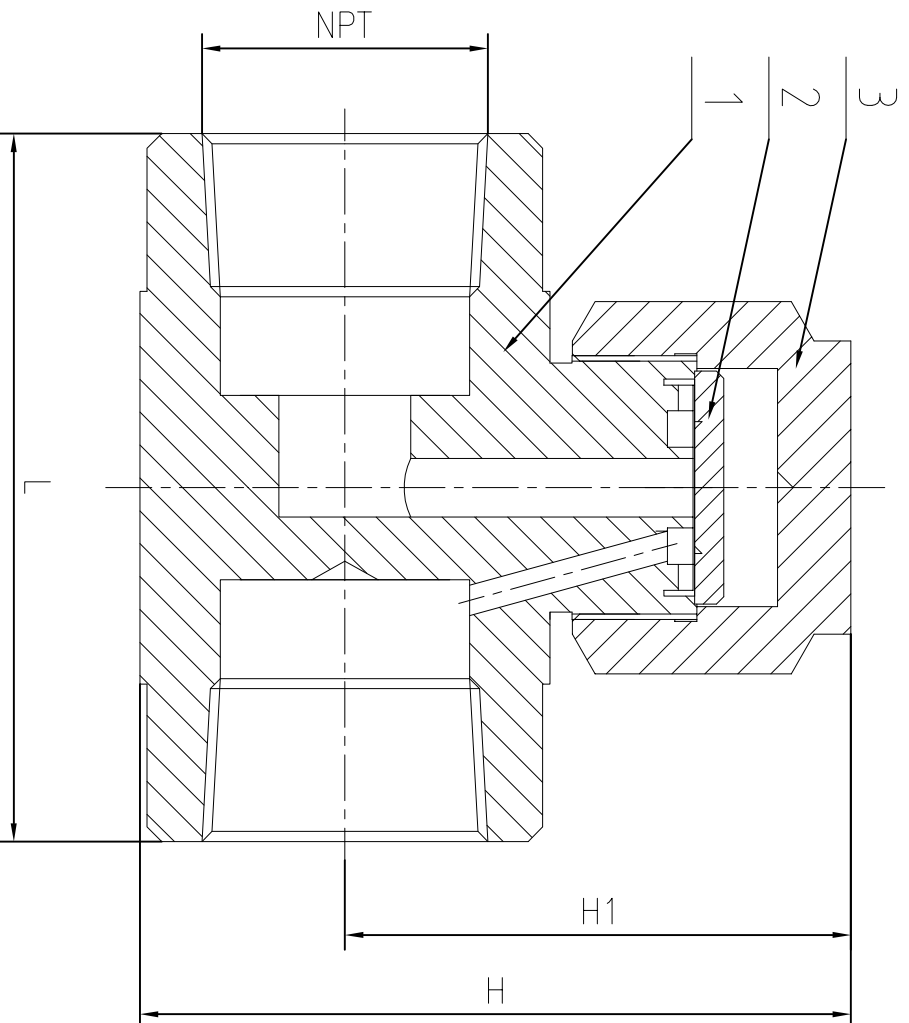

Performance Standard

1. Nominal Pressure: Rating PN64
2. Temperature: below 425°C
3. NPT Thread connection Std: ASME B1.20.1
4. Design & manufacture as to: ASME B16.34
5. Testing & Inspection as to: API 598

THERMODYNAMIC
STEAM TRAP



NPS 1/2"~1"
PN64 NPT